

Grab Rails

Prices subject to change without notice.



WALTERS' SWIM SUPPLIES, INC.

Website: www.walterswim.com Email: walterswim@sbcglobal.net

In WI: 1-262-790-9199 Fax: 1-262-790-9043 Toll Free: 1-800-558-0428

GRAB RAILS

Because competition pools require unobstructed racing lanes and steps built into the wall, grab rails are a necessity.

Paragon grab rails are made of one continuous length of smooth, corrosion resistant, T304 stainless steel tube, 1.90" diameter with wrinkle-free bends.

Seven styles are available; choose the one that most closely fits your needs: the heavier the traffic, the heavier the tubing you should select. Custom designs are available upon request.

Order separately: 4 anchor sockets and escutcheon plates for each pair of grab rails.

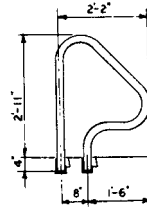
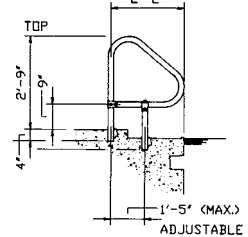

Figure 4

Our most popular model. Use this style when deck is flat and without unusual curbs or coping.

		Pair	Multiple Pair
I.D. No. 30101	.145" wall	\$591.85	\$557.45
I.D. No. 30102	.109" wall	516.25	486.25
I.D. No. 30103	.065" wall	303.75	286.10

Ask for Spec. Sheet 20.41



Adjustable

Front leg is adjustable in field so it can be set atop curbs or into gutters. Choose this model when unusual conditions will not permit use of Figure 4 style.

		Pair	Multiple Pair
I.D. No. 30301	.145" wall	\$752.85	\$709.10
I.D. No. 30302	.109" wall	701.35	660.60
I.D. No. 30303	.065" wall	400.20	376.95

Ask for Spec. Sheet 20.45

BUILT IN STEPS

For use in conjunction with grab rails. Steps are grouted into a rough hole formed in the wall during pouring or guniting. Gives smooth walls for unobstructed racing lanes in competition pools. For recreational or residential pools, the smooth walls permit the use of automatic cleaners.

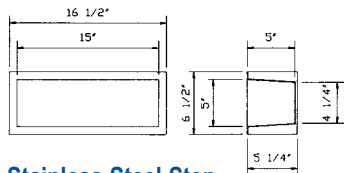
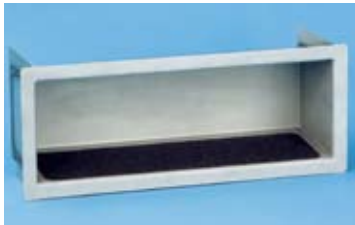

Stainless Steel Step

Fabricated of polished, corrosion-resistant, stainless steel, tread at bottom is sand blasted for non-skid traction. Sets flush in wall. Can be used in all climates.

I.D. No. 32104 \$234.00 Each

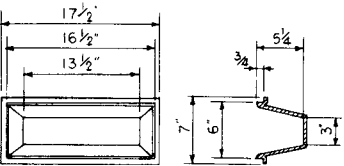

Frostproof Step

Heavy duty, foamed plastic without projecting lip. Specifically recommended for use in freezing climates. White with textured bottom tread for added traction.

I.D. No. 32102 \$61.90 Each

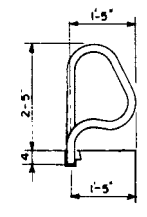

Pretzel Bend

Requires the least amount of deck width. Can usually be mounted on pool wall rather than the deck slab. Has the narrowest profile as the legs are offset laterally instead of front to back.

		Pair	Multiple Pair
I.D. No. 30201	.145" wall	\$535.15	\$504.05
I.D. No. 30202	.109" wall	506.45	477.00
I.D. No. 30203	.065" wall	312.85	294.70

Ask for Spec. Sheet 20.43

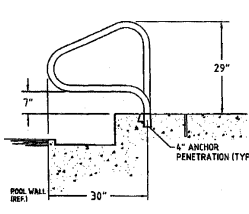

Long Reach Pretzel

Recommended for installations with wide gutter systems and limited amount of deck space.

		Pair	Multiple Pair
I.D. No. 30211	.145" wall	\$764.60	\$720.15
I.D. No. 30212	.109" wall	651.20	613.30
I.D. No. 30213	.065" wall	402.80	379.40

Ask for Spec. Sheet 20.50

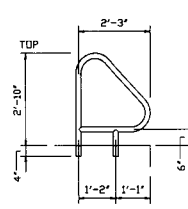

Welded

If you furnish specific deck and gutter dimensions we can supply our Adjustable Grab Rail styling as a fixed fully-welded unit.

		Pair	Multiple Pair
I.D. No. 30511	.145" wall	\$653.15	\$615.15
I.D. No. 30512	.109" wall	571.65	538.40
I.D. No. 30513	.065" wall	359.15	338.25

Ask for Spec. Sheet 20.46

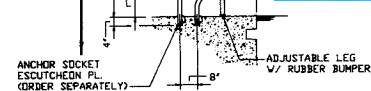
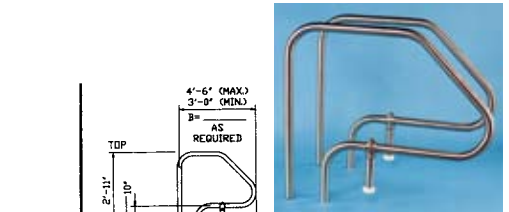

Long Reach Adjustable

Available in sizes to fit extra wide gutter systems in the increasingly popular "fast pool" design concept. Custom fabricated to pool profile.

		Pair	Multiple Pair
I.D. No. 30320	.145" wall	\$947.75	\$892.65
I.D. No. 30321	.109" wall	939.95	885.30
I.D. No. 30322	.065" wall	453.65	427.30

Ask for Spec. Sheet 20.49

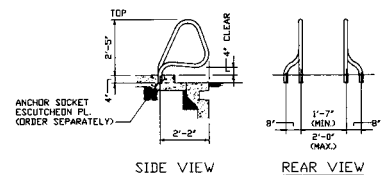

California

For pools with extra-wide gutters, or when deck-to-water distance is exceptionally large. Made extra wide to clear unusual gutters with legs offset laterally to minimize deck width requirements. Front end dips downward providing a shorter reach for low-water-level pools.

		Pair	Multiple Pair
I.D. No. 30401	.145" wall	\$641.40	\$604.10
I.D. No. 30402	.109" wall	571.65	538.40
I.D. No. 30403	.065" wall	316.80	298.35

Ask for Spec. Sheet 20.47